

# SCHEME G1

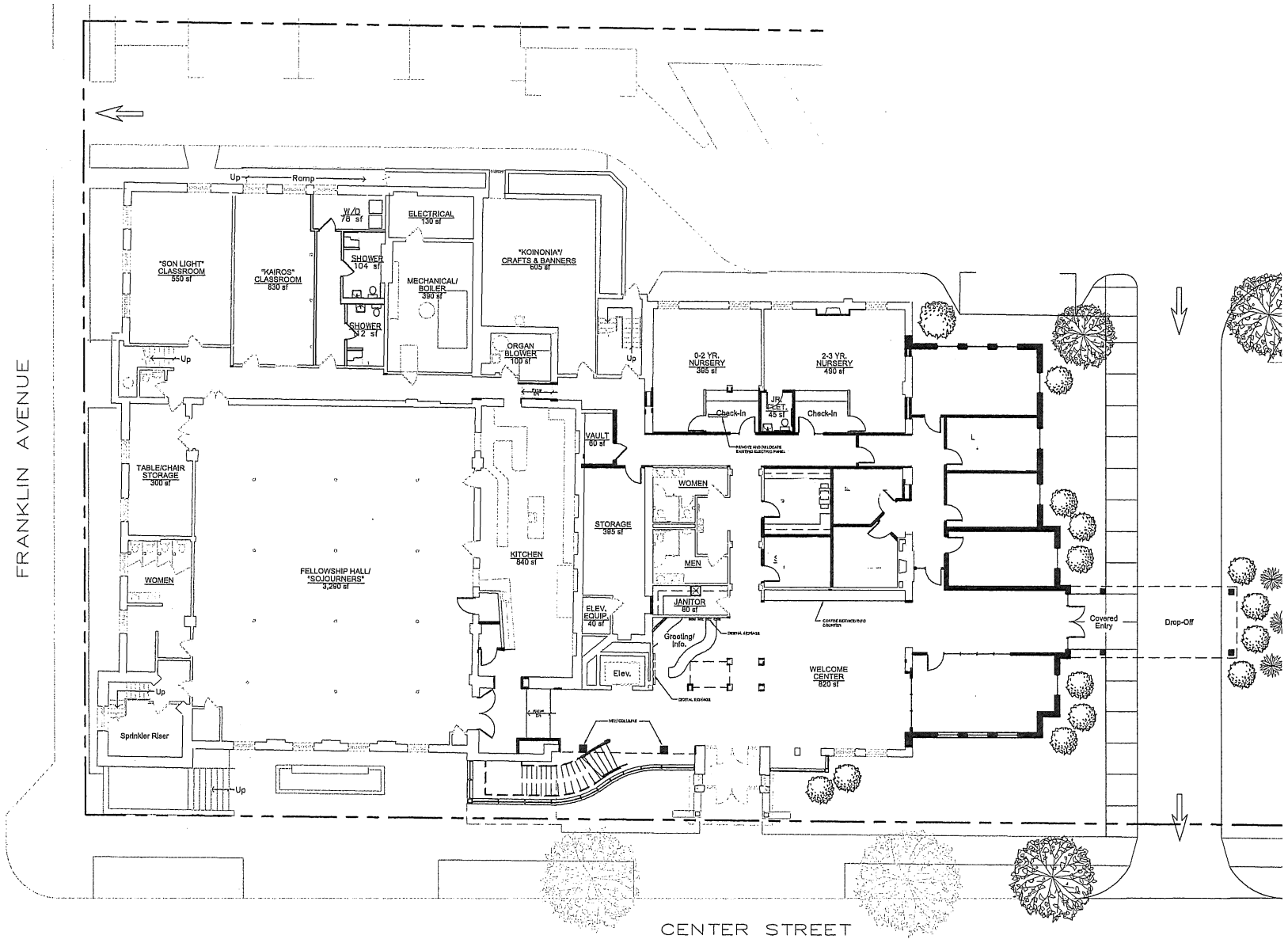

1/8"=1'-0" 1 SCHEMATIC FLOOR PLAN – Ground Level

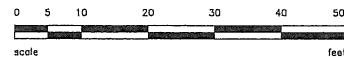

David F. Schultz Associates, Ltd.

SCHEMATIC DESIGN

COMMUNITY UNITED METHODIST CHURCH

NAPERVILLE

REVISIONS

NO.	DATE	DESCRIPTION

NOT FOR CONSTRUCTION

DATE  
 APRIL 20, 2015  
 PROJECT NUMBER  
 1109  
 SHEET NUMBER

A-2.1

© David F. Schultz Associates, Ltd. All Rights Reserved.

## Building to Serve

### Phase 1

The current schedule, which has to be somewhat tentative at this point, sets the beginning date as May 16, 2016, with the entire project to be completed by the end of 2016.

- The first floor will be remodeled with an addition to provide:
  - ◇ a welcome center,
  - ◇ a relocated nursery, and
  - ◇ an attractive, secure office complex.
- The remainder of the building plus the new addition will be equipped with a sprinkler system.
- The renovated first floor area and the addition will be heated and cooled by a new state-of-the-art forced air VRV system.
- In addition, the unfinished exterior of the second floor addition will be done (with the interior work being completed in the next phase of the building program).

